

HARBOUR CITY

502

€446,688 + VAT

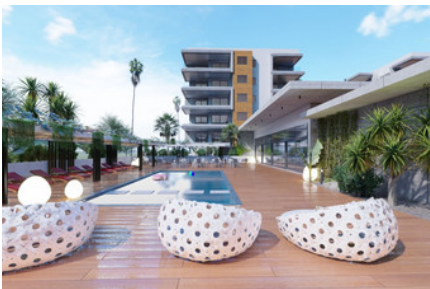

 Bedrooms: 3

 Bathrooms: 3

 Internal covered: 107.43m²

 Status: Key ready

 Pool: Communal

 Parking: Covered

P R O P E R T Y F O R S A L E

HARBOUR CITY

OVERVIEW

 Limassol, Zakaki



Penthouse

502

DESCRIPTION

Living at one of Limassol's most upcoming locations is more than great...it is all about absorbing the vibe of one of the most cosmopolitan Mediterranean destinations right next to the city's world-famous harbour. Harbour City, an impressive residential project, is defined by its location, the sense of a true and authentic community and the endless potential of constant growth all around it.

THE PROJECT

Harbour City, as its name suggests, is a landmark residential development to define the western part of Limassol. A total of 13 residential blocks, each boasting 5 floors, provide comfortable and effortless living.

FACILITIES

Aircondition, Provision

Heating, Provision

Parking, Covered

Pool, Communal

Elevator

Childrens playground

Gated complex

Clubhouse

FEATURES

Combined kitchen and dining area

Elevated

Balcony

Entrance gate

Investment opportunity

Ceramic tiles

Laminate flooring

Double glazing

Guest WC

Veranda

Quiet area

En suite bathroom

Modern design

Near bus route

Near amenities

DISTANCES

Amenities: 500 m

Airport: 60 km

Sea: 1 km

Public transport: 500 m

Schools: 100 m

Resort: 1 km