

**AFFORDABLE ELEGANCE**

# YOOF APARTMENTS

# YOOF APARTMENTS

---

Yoof Apartment is located in the heart of Limassol city, just 300 meters away from the seaside. It takes only 1 minute to reach the beach and the central pedestrian street, making its location extremely advantageous. Situated in the bustling life of the Mediterranean city, it is the perfect choice for investment or personal residence.

## CONTENT

---

|                  |       |
|------------------|-------|
| YOOF APARTMENTS  | 3     |
| THE PROJECT      | 8-9   |
| THE DETAILS      | 10-15 |
| TURNKEY FINISHES | 16-17 |
| COMFORT LIVING   | 18-19 |
| THE LOCATION     | 20-21 |
| MAP              | 22-23 |
| UNITS            | 24-25 |
| PLANS            | 26-33 |
| KALEIDE          | 34-35 |
| CONTACT          | 36    |



4





# THE PROJECT

---











Modern design

Two-bedroom apartments

Private parking

Covered Veranda

# THE DETAILS

-  Apartments: 6
-  Bedrooms : 2
-  Bathrooms : 2
-  Floors : 1-3
-  Parking Spaces: 1
-  Internal Covered: 74.03 - 75.78 m<sup>2</sup>
-  Covered Veranda: 19.13 - 20.68 m<sup>2</sup>
-  Communal Area: 7.86 m<sup>2</sup>
-  Status: Off Plan
-  Energy Efficiency Rating: A
-  Delivery Date: 2025





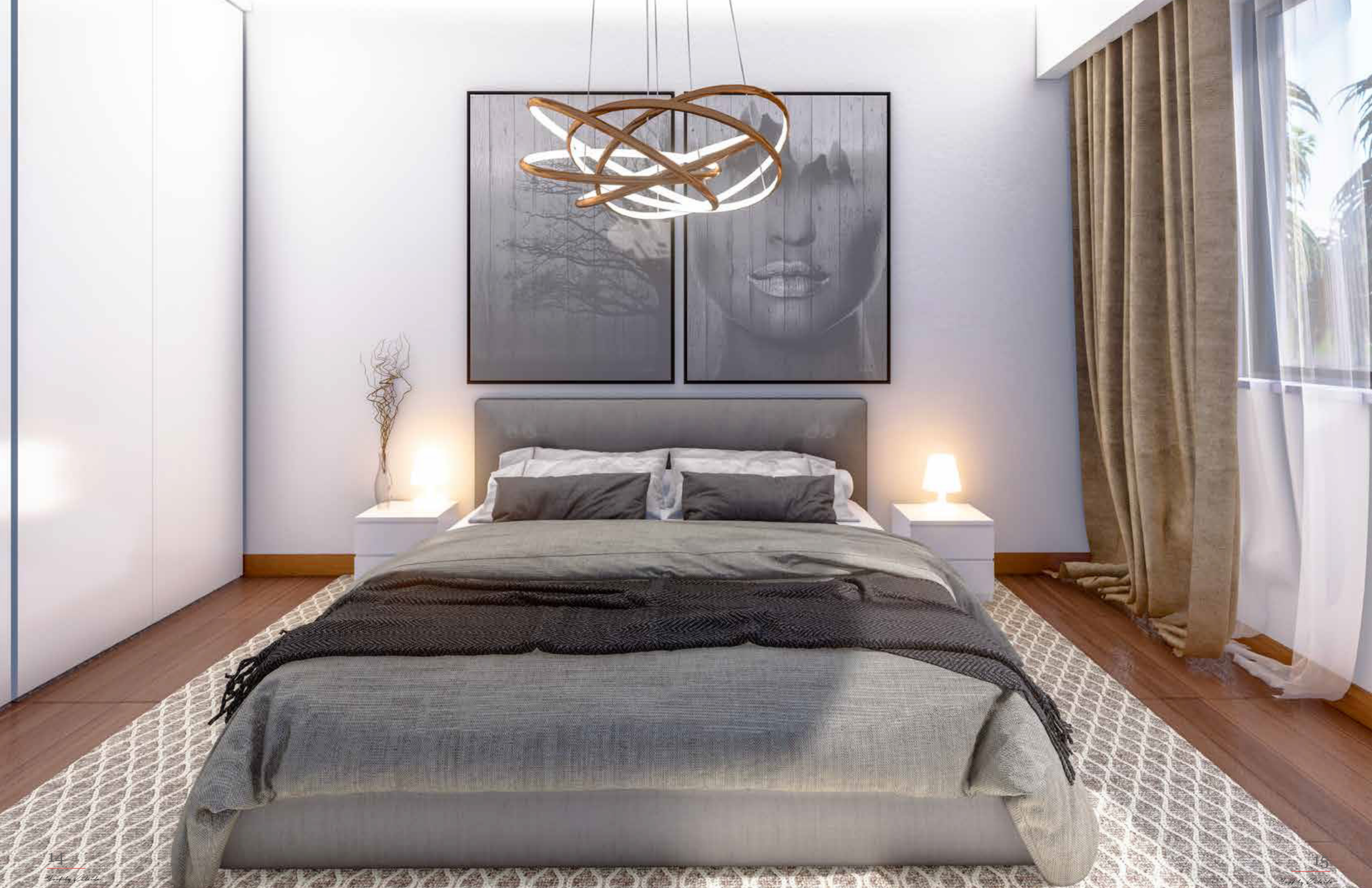





## TURNKEY FINISHES

- Energy Efficiency Rating: A
  - High-quality tiles
- High-quality european laminate floors
- High-quality non-slip tiles for bathrooms
  - Double-layer aluminum insulation glass windows
  - Provision for split air conditioner
  - European brand sanitary ware
- Eu standard high quality kitchen cabinets and wardrobes
  - Countertops in synthetic granite

# COMFORT LIVING

---

With its prime location, all amenities within walking distance, it's the ideal choice for both investment and living. The two-bedroom apartments come with balconies, open-plan living rooms, and are constructed using high-quality materials from the European Union. Italian-style wardrobes and kitchens, double-glazed windows, and parking facilities are included. Situated in the heart of the city, with mature infrastructure and in a bustling area, it provides you with a cozy home.





## LOCATION BENEFITS

Historical city Centre

Near by New Marina and Anexartisia  
Shopping Street

Close to all necessary amenities

Developed infrastructure

Modern living

200m to the Seaside

4



# YOOF APARTMENTS

Four Seasons  
Mediterranean

# UNITS

---

| No     | Floors | Type      | Bedrooms | Bathrooms | Covered Internal (sq.m) | Covered Veranda (sq.m.) | Roof Garden (sq.m.) | Uncovered Veranda (sq.m.) | Parking | Total Covered (sq.m.) | Common Area (sq.m.) | Total Area (sq.m.) |
|--------|--------|-----------|----------|-----------|-------------------------|-------------------------|---------------------|---------------------------|---------|-----------------------|---------------------|--------------------|
| No 101 | 1      | Apartment | 2        | 2         | 75.78                   | 20.68                   | 0                   | 0                         | 1       | 96.46                 | 7.86                | 104.32             |
| No 102 | 1      | Apartment | 2        | 2         | 75.43                   | 20.37                   | 0                   | 0                         | 1       | 95.80                 | 7.86                | 103.66             |
| No 201 | 2      | Apartment | 2        | 2         | 75.08                   | 20.06                   | 0                   | 0                         | 1       | 95.14                 | 7.86                | 103.00             |
| No 202 | 2      | Apartment | 2        | 2         | 74.73                   | 19.75                   | 0                   | 0                         | 1       | 94.48                 | 7.86                | 102.34             |
| No 301 | 3      | Apartment | 2        | 2         | 74.38                   | 19.44                   | 0                   | 0                         | 1       | 93.82                 | 7.86                | 101.68             |
| No 302 | 3      | Apartment | 2        | 2         | 74.03                   | 19.13                   | 0                   | 0                         | 1       | 93.16                 | 7.86                | 101.02             |

# Ground Floor

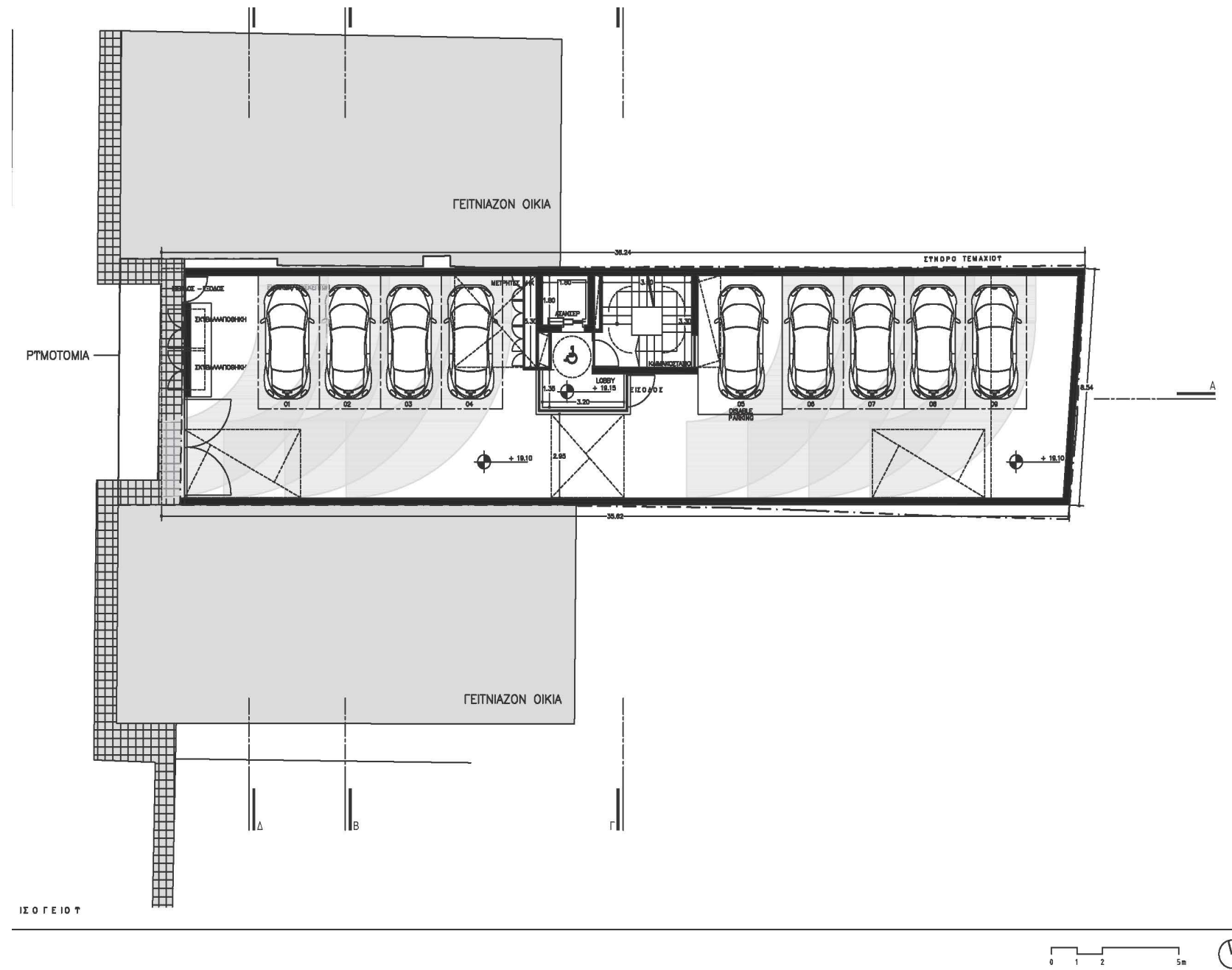

# 1st Floor

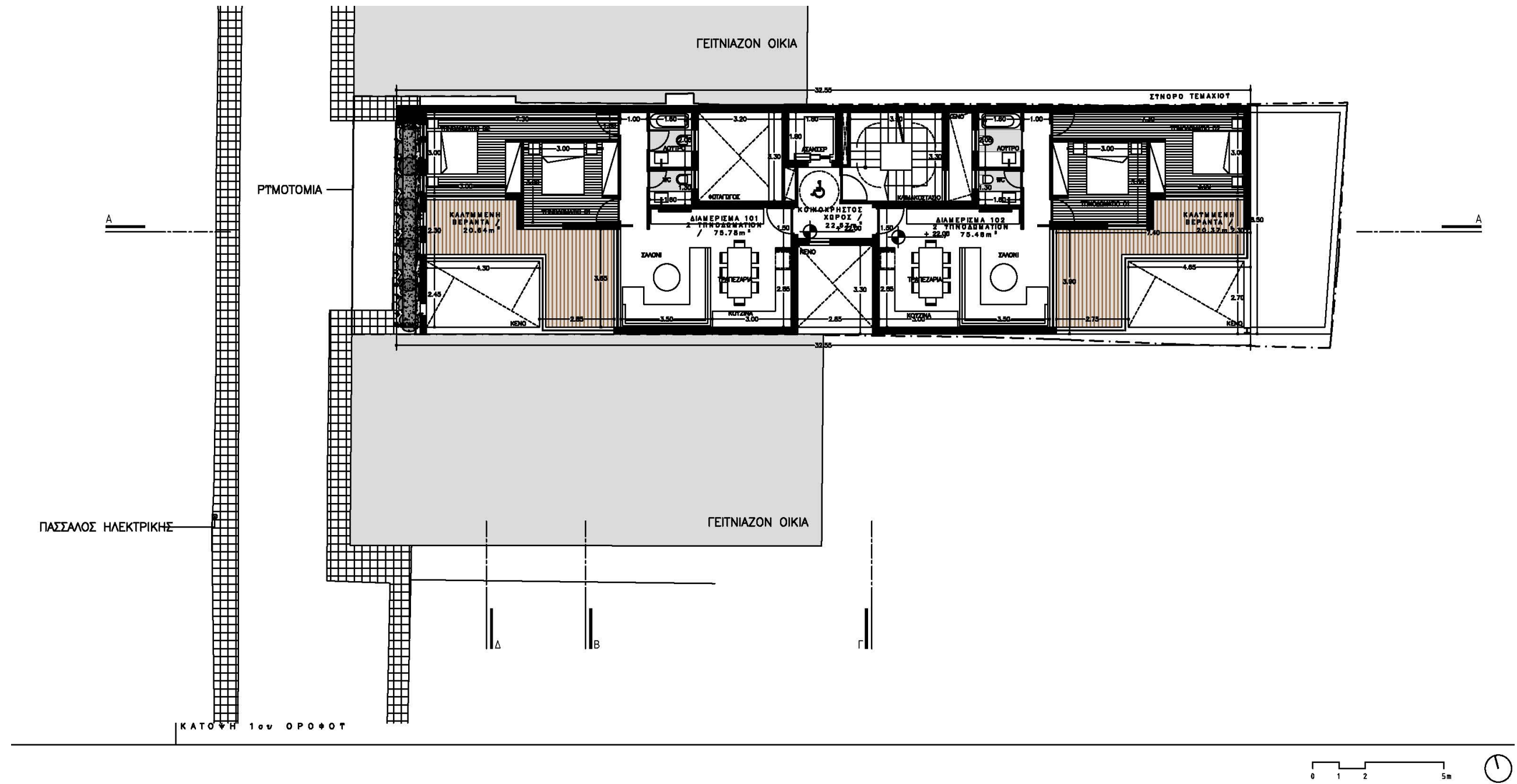







# KALEIDE

---

*Build your dream*

**Kaleide Property Group** is a real estate development company based in Cyprus with an impressive portfolio of ground-breaking projects.

Through its **SMART** property package, Kaleide offers affordable elegance accessible for family living or for long-term investment while through its **SELECT** package, it boasts a selection of properties, addressed to the high-end buyer.

With a focus on the transparency of the procedure, Kaleide offers premium residential and commercial properties for discerning clients. We work openly and with transparency with all our partners, promoting an inclusive and diverse brand strategy and aim to promote better living for all through sustainable and smart projects with a flair for high aesthetics.

Our team's combined experience enables us to be local experts with global industry knowledge, transforming Cyprus's property market and creating a new approach for real estate.

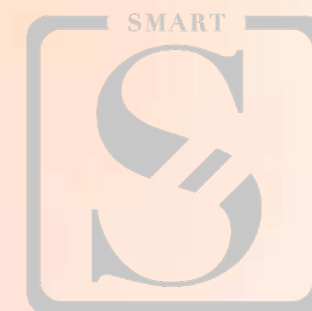

AFFORDABLE ELEGANCE



PREMIUM ELEGANCE

# CONTACTS

---

 [www.kaleidgroup.com](http://www.kaleidgroup.com)

 +357 25 100 688

 [info@kaleidgroup.com](mailto:info@kaleidgroup.com)

 Leoforos Amathountos 2, Sun City Beach Complex  
Shop 1-2, 4531, Mouttagiaka Limassol

